



CONTACT

HEAD OFFICE BHOPAL
 13-A & 12-D - Sector-D
 Industrial Area, Govindpura,
 Bhopal - 462 023, India.
 Tel : 0755-4233535(30 Lines)
 26062661/662
 Fax : 0755-4270730,
sanfield@sanfieldindia.in

DELHI OFFICE
 B-7, 2nd Floor, South Extension - II,
 New Delhi - 110 049
 Tel : 011- 46026903
sanfielddelhi@sanfieldindia.in

MUMBAI OFFICE
 Hind Saurashtra Industrial Co-op.
 Society Ltd.
 Unit No. B-17, Marol Naka,
 Andheri Kurla Road,
 Andheri (E) Mumbai - 400059
 Tel.: 022-28500275/276
sanfieldmumbai@sanfieldindia.in

AHMEDABAD sanfieldahmedabad@sanfieldindia.in +918980314418	BANGALORE sanfieldbangalore@sanfieldindia.in +9180500 10502	CHENNAI sanfieldchennai@sanfieldindia.in +919840165062
HYDERABAD sanfieldhyderabad@sanfieldindia.in +919977271110		PUNE sanfieldpune@sanfieldindia.in +91 7722089602



www.sanfieldindia.in

SIL GROUT-IT[®]



PRECAST SPLICING SOLUTION

Sanfield [India] Limited.



SIL GROUT-IT

Sanfield GROUT-IT provides an economic, effective solution for design of precast elements in Construction. Precast concrete construction is gaining popularity worldwide, The same is because of faster turnaround time and precise executions. GROUT-IT compliments this need.

Sanfield is a Leading construction solution provider, We have developed GROUT-IT system to create rebar continuity between precast concrete elements.

GROUT-IT Benefits

- | | | |
|--|---|---|
| 1 Structural Integrity between the precast sections. | 2 Load Path Continuity, Reinforcement acts as a continuous bar. | 3 Helps overcoming misalignment issues. |
| 4 Eliminates field welding damage to concrete. | 5 Faster Execution | 6 Freedom of using mortar best suited to application. |

GROUT-IT Applications

GROUT-IT coupler is designed to connect wall or column precast elements either horizontally and vertically.

In horizontal applications, and in vertical applications with the GROUT-IT coupler installed in the top element, the connection is achieved by injecting the GROUT-IT through the inlet pipe.

In vertical applications with the GROUT-IT coupler installed in the bottom element, the GROUT-IT can simply be poured by gravity directly into the coupler cavity.

GROUT-IT Specs

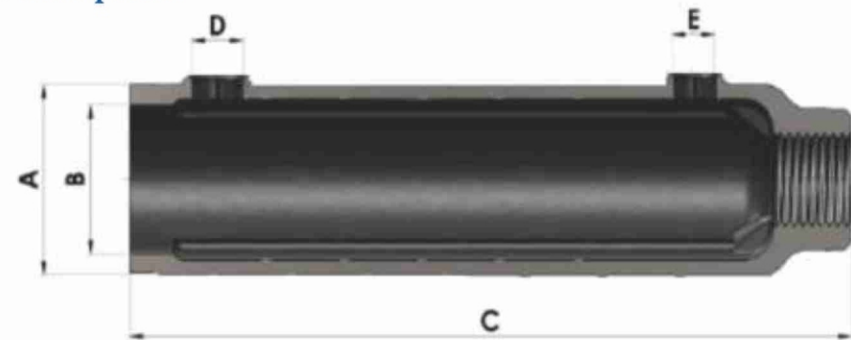

COUPLER DIMENSION (in mm)

Bar size	A	B	C	D	E	Min rebar Engagement length	Max rebar Engagement length
12	61	44	150	25	20	110	125
16	61	44	182			140	155
20	65	48	260	25	20	200	225
25	68	50	285			225	235
32	81	62	290			230	245
40	95	72	340			270	290

Installing GROUT-IT

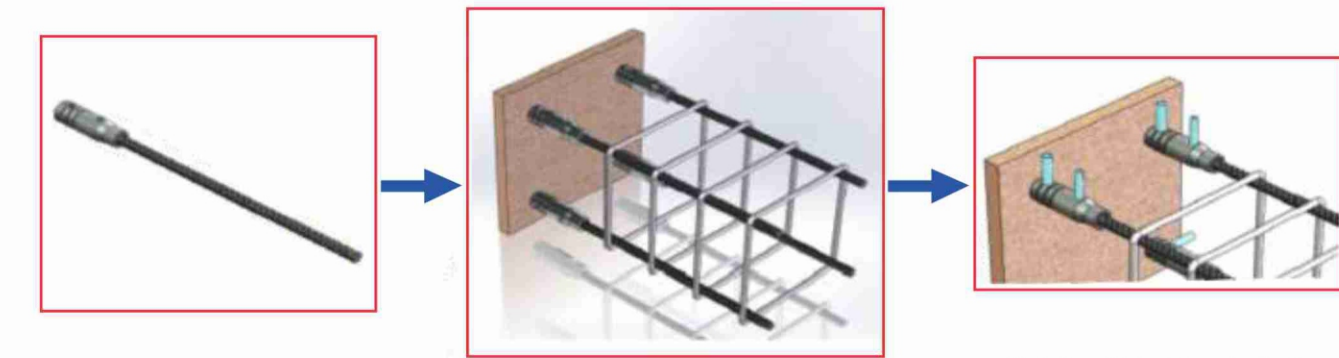
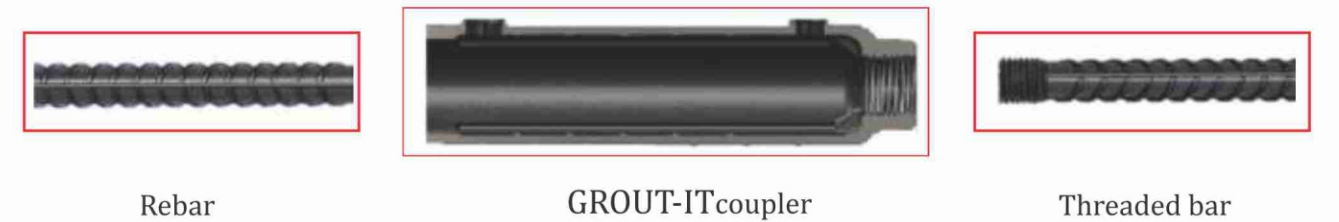

Screw the coupler onto the bar. Make sure that its unthreaded end is sealed by a plastic cap.

Ensure that all the bars are flush with the formwork.

Cut the injection and air vent tubes at the suitable length so that they are flush with the formwork.

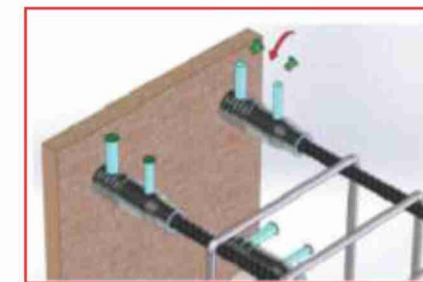

Insert the plugs into the injection and air vent tubes.

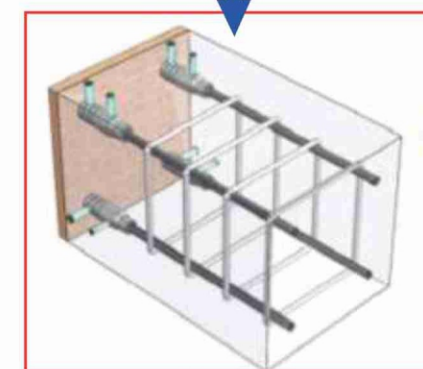

Close the formwork and cast the concrete. after formwork removal, remove the plastic caps from the couplers.

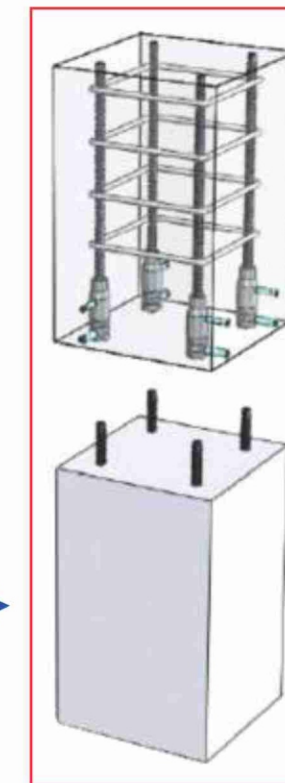

Bring the pre-cast element to site. Check that the bars protruding from the previous element are long enough. Insert the new element over the previous one.

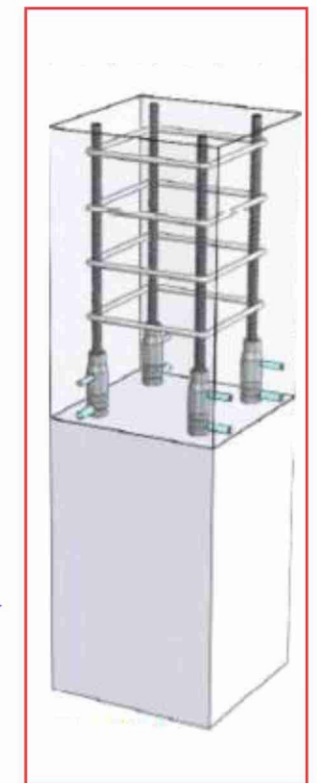

Inject the GROUT-IT until it comes out of the air vents. Put the plugs back in place after finishing each injection.